

NEW HAVEN CITY PLAN COMMISSION ADVISORY REPORT

RE: 55 DICKERMAN STREET (MBP 295-0306-03200), Land Disposition to rehabilitate two-family dwelling for sale or rent (Sampedro, Cruz)
REPORT: 1470-09
ADVICE: Approval with Conditions

PROJECT SUMMARY:

Developer: Alejandro Sampedro & Virginia Cruz
Disposition Price: \$8,000
Site: 6,300 S.F.
Zone: RM-2
Use: Single family dwelling
Financing: Private
Subsidy: None
City Lead: Evan Trachten
Agency: Livable City Initiative
Phone: 946-8373

BACKGROUND:

The City acquired this parcel and proposes to sell it to Alejandro Sampedro & Virginia Cruz who will rehabilitate the existing single family dwelling and become owner occupants of this property. A recent site visit shows Dickerman Street comprised of single and multi-family dwellings. 55 Dickerman is currently in disrepair and vacant. Off street parking is not available on site.

PLANNING CONSIDERATIONS:

Evaluation of the site was based on examination of the City Tax Map and a site visit as rehabilitation plans were not submitted for review. The City proposes to sell 55 Dickerman for \$8,000 and the estimated cost of improvements is unknown. The Commission has not addressed the issue of price. The building is listed on the City's Historic Resources Inventory.

ADVICE:

The Commission finds the proposed reuse of the property suitable for the site in question and therefore recommends approval with conditions:

1. Any planned exterior rehabilitation shall take into account the prior appearance of the house, and that any remaining historic architectural features shall be preserved in accord with *Secretary of the Interior's Standards for Rehabilitation and Guidelines for Rehabilitation Historic Buildings* if economically feasible.
2. Outline of proposed rehabilitation work shall be submitted to the City Plan Department.

ADOPTED: October 17, 2012
Roy Smith, Jr.
Vice Chair

ATTEST: 
Karyn M. Gilvarg, AIA
Executive Director

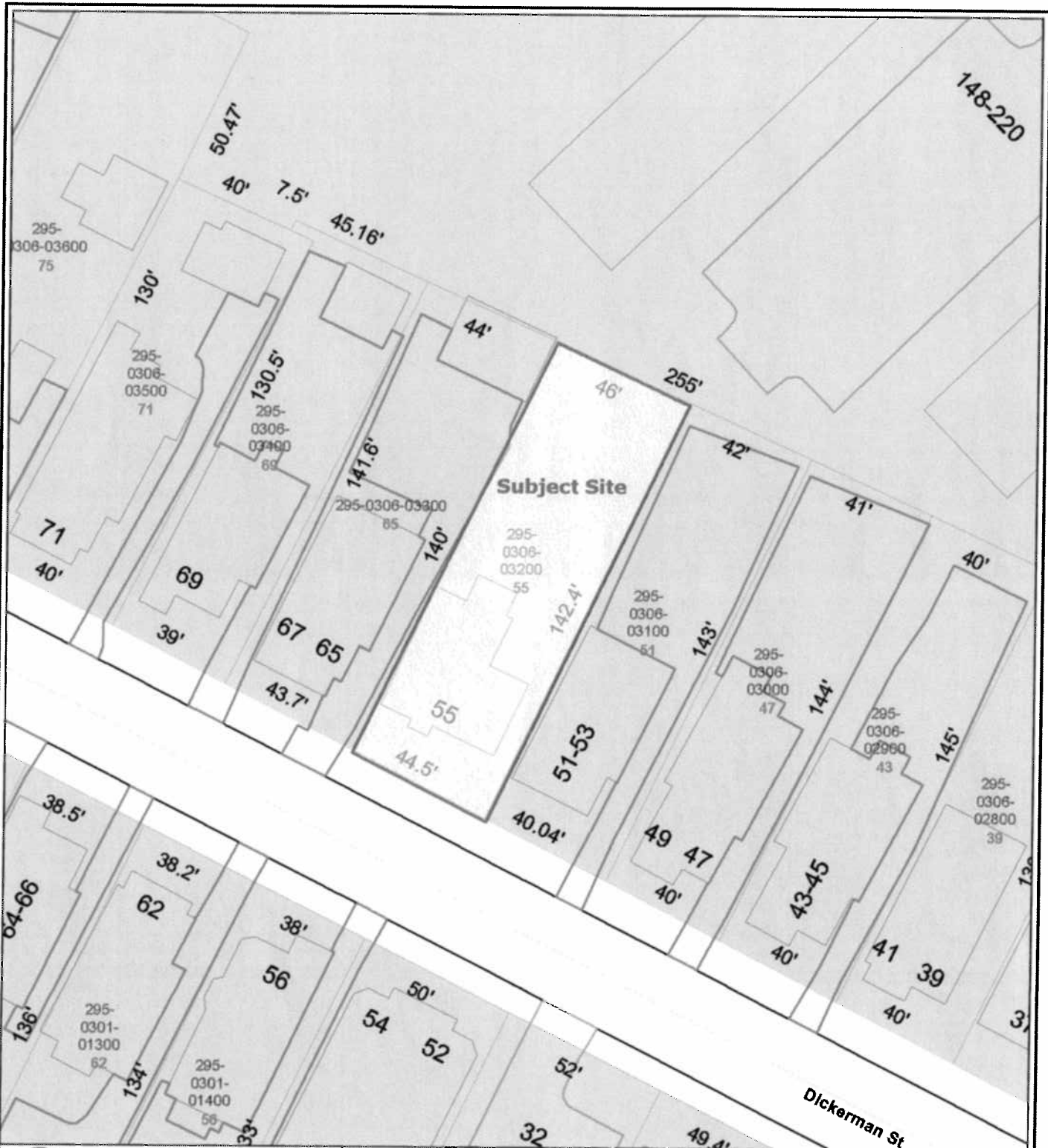

City of New Haven, Connecticut
John DeStefano Jr., Mayor



55 Dickerman Street

Produced by the
Office of Information Technology
Geographic Data Viewer

- | | |
|---|--|
| <p>Waterway</p> <ul style="list-style-type: none"> — Lake - Pond — River — Shoreline — Stream — Wetland <p>Parcel</p> <ul style="list-style-type: none"> — City Boundary Line <p>Schools</p> <ul style="list-style-type: none"> — Administration — Food Service — Private School — Public School — Fire Station <p>Police Station</p> <ul style="list-style-type: none"> — PD Headquarters — Substation — Health Centers — Hospital — Library | <p>Railroad</p> <ul style="list-style-type: none"> — Railroad Track — Abandoned Railroad Track — Airport Runway — Parcel Line_2005 <p>Parks</p> <ul style="list-style-type: none"> — Park — Triangle — Golf Course — Land Trust Preserves — Airport boundary — Shoreline |
|---|--|

This map is intended for illustrative and Community-Based Planning processes. Every reasonable effort has been made to assure the accuracy of the map and data provided; nevertheless, some information may not be accurate. The City of New Haven assumes no responsibility arising from the use of this information.

No warranty is made by the City of New Haven as to the accuracy, reliability or completeness of these data for individual or aggregate use with other data. Original data compiled from various sources. Spatial information may not meet national map accuracy standards. This information may be updated without notification.

Scale: 1" = 42 ft

Created: September 26, 2012

