

# NEW HAVEN CITY PLAN COMMISSION ADVISORY REPORT

**RE:** 125 PINE STREET (MBP 161-0784-01500), Land Disposition Agreement for rehabilitation of existing 3-family dwelling by owner occupant [Perez].  
**REPORT:** 1470-08  
**ADVICE:** Approval

## PROJECT SUMMARY:

---

**Developer:** Wilfredo Perez  
**Disposition Price:** \$70,000  
**Site:** 4,450 S.F.  
**Zone:** RM-1  
**Use:** Rehabilitate 3-family dwelling  
**Financing:** Private  
**Subsidy:** None  
**City Lead:** Evan Trachten  
**Agency:** Livable City Initiative  
**Phone:** 946-8373

## BACKGROUND:

The City acquired this parcel and proposes to sell it to Mr. Wilfredo Perez who will rehabilitate the existing 3-family dwelling and become owner occupant of this property. The existing 3-story house is currently in disrepair. Limited off street parking is available on the site which is at the corner of Pine and Rowe Streets.

## PLANNING CONSIDERATIONS:

Evaluation of the site was based on examination of the City Tax Map as rehabilitation plans were not submitted for review. The City proposes to sell 125 Pine Street for \$70,000 and the estimated cost of improvements is unknown. The Commission has not addressed the issue of price.

## ADVICE:

The Commission finds the proposed reuse of the property suitable for the site in question and therefore recommends approval.

**ADOPTED:** October 17, 2012  
Roy Smith, Jr.  
Vice Chair

**ATTEST:**   
Katyn M. Gilvarg, AIA  
Executive Director

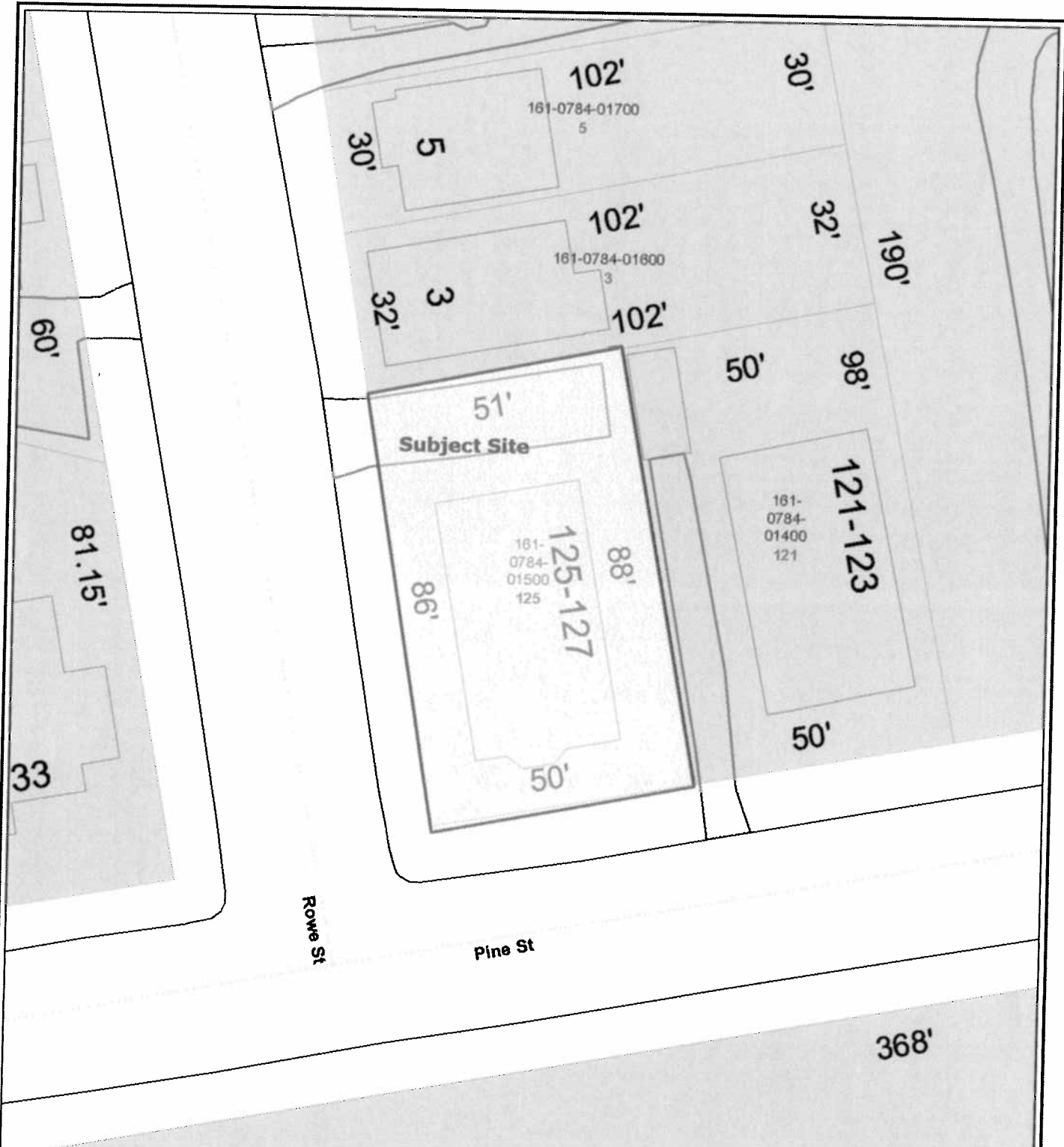

City of New Haven, Connecticut  
John DeStefano Jr., Mayor



**125 Pine Street**

Produced by the  
Office of Information Technology  
Geographic Data Viewer

- |  |   |
|--|---|
| <ul style="list-style-type: none"> <li>Waterway</li> <li>--- Lake - Pond</li> <li>--- River</li> <li>--- Shoreline</li> <li>--- Stream</li> <li>--- Wetland</li> <li>Parcel</li> <li>--- City Boundary Line</li> <li>Schools</li> <li>■ Administration</li> <li>■ Food Service</li> <li>■ Private School</li> <li>■ Public School</li> <li>● Fire Station</li> <li>Police Station</li> <li>▲ PD Headquarters</li> <li>▲ Substation</li> <li>■ Health Centers</li> <li>■ Hospital</li> <li>■ Library</li> </ul> | <ul style="list-style-type: none"> <li>Railroad</li> <li>--- Railroad Track</li> <li>--- Abandoned Railroad Track</li> <li>--- Airport Runway</li> <li>--- Parcel Line_2005</li> <li>Parks</li> <li>■ Park</li> <li>■ Triangle</li> <li>■ Golf Course</li> <li>■ Land Trust Preserves</li> <li>■ Airport boundary</li> <li>■ Shoreline</li> </ul> |
|--|---|

This map is intended for illustrative and Community-Based Planning processes. Every reasonable effort has been made to assure the accuracy of the map and data provided; nevertheless, some information may not be accurate. The City of New Haven assumes no responsibility arising from the use of this information.

No warranty is made by the City of New Haven as to the accuracy, reliability or completeness of these data for individual or aggregate use with other data. Original data compiled from various sources. Spatial information may not meet national map accuracy standards. This information may be updated without notification.

Scale: 1" = 27 ft

Created: September 26, 2012

